

MODEL 163.113 /128 /136 /154 /157 /172 /174 /175

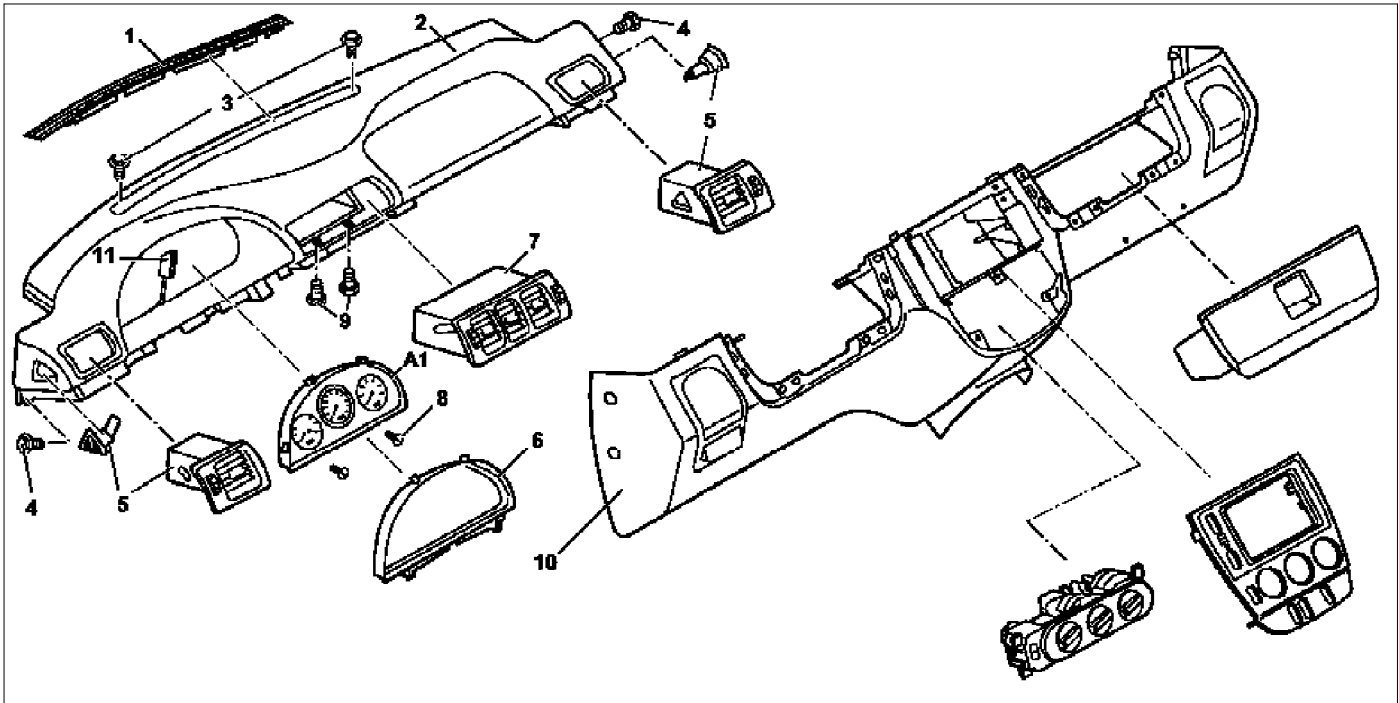





P68.10-0611-09

1 Upper air outlet cover
 2 Instrument panel
 3 Bolts
 4 Bolts
 5 Left and right side air nozzles

6 Instrument cluster cover frame
 7 Center air nozzle
 8 Plastic screws
 9 Bolts

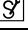
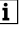
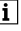
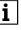
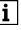
10 Bottom section of instrument panel
 11 Plug connector to instrument cluster
 A1 Instrument cluster

 	Remove/install		
1	Remove instrument panel bottom section (10)		AR68.10-P-1040GH
2	Remove A-pillar trim on left and right		AR68.30-P-4050GH
3	Remove upper section of air outlet panel (1)	 Long wedge	*115589035900
4	Unscrew screws (3) from upper side of instrument panel		
5	Remove instrument cluster (A1 remove)		AR54.30-P-6015GH
6.1	Disconnect sun sensor connector	 Only as of 01.09.01: Connector is located behind instrument cluster	
7.1	Remove Parktronic display	 Only with Parktronic system (PTS), Code 220a.	AR54.65-P-0003GH
8.1	Disconnect connector from actuator motor for air distribution flap	 Only as of 01.09.01: Connector is located at center air outlet nozzle on driver's side.	
9.1	Disconnect connector from temperature sensor	 Only as of 01.09.01: Connector is located on right side of center air outlet nozzle.	
10	Remove screws (9) from center of instrument panel		
11	Remove screws (4) from sides of instrument panel		
12	Remove instrument panel (2)	 Danger of damaging instrument panel when removing and installing	
13	Install in the reverse order		

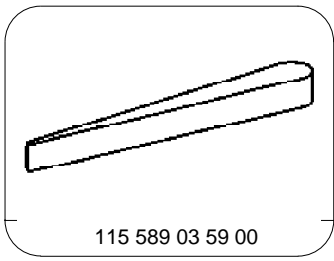

Long wedge