

TRANSMISSION 722.6 in MODEL 163

Illustrated up to VIN A145272, X708318

- 1 Torque converter housing
- 2 13-pin plug connection
- 3 Oil filler pipe
- 4 Oil lines
- 5 Shield
- 6 Shield fixing bolt
- 7 Cable for park lock interlock
- 8 Adapter housing for transfer case
- 9 Left exhaust bracket
- 10 Right exhaust bracket
- 11 Retaining plate
- 12 Exhaust bracket bolt
- 13 Oil line bolt
- 14 Oil drain plug to oil pan

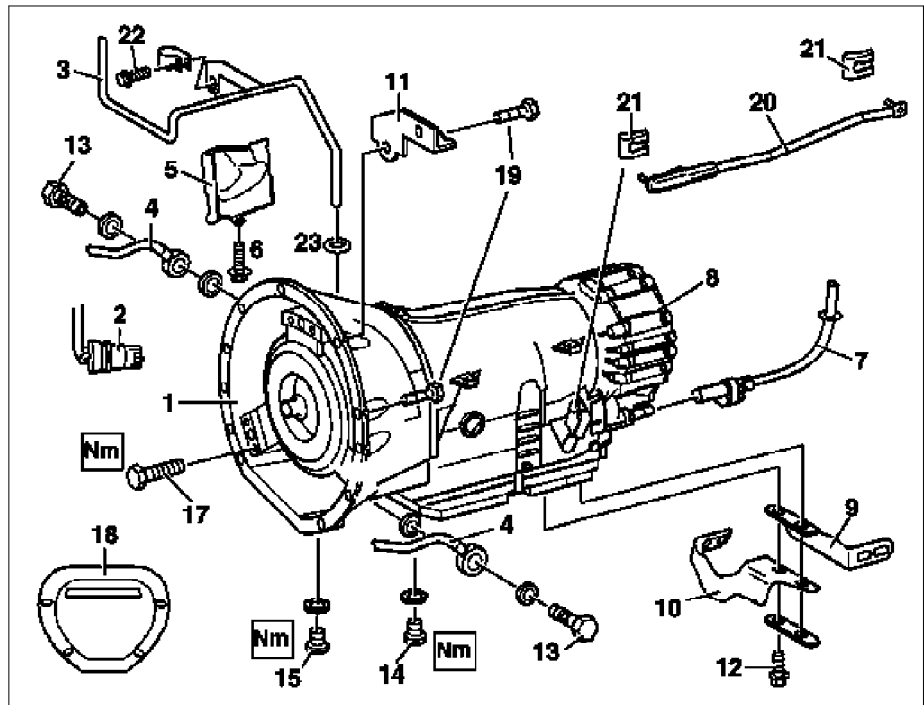

P27.10-0321-06

- 15 Oil drain screw for torque converter
- 17 Torque converter bolt
- 18 Cover in oil pan
- 19 Transmission bolts
- 20 Shift rod
- 21 Securing clips
- 22 Bolt, oil filler pipe
- 23 O-ring

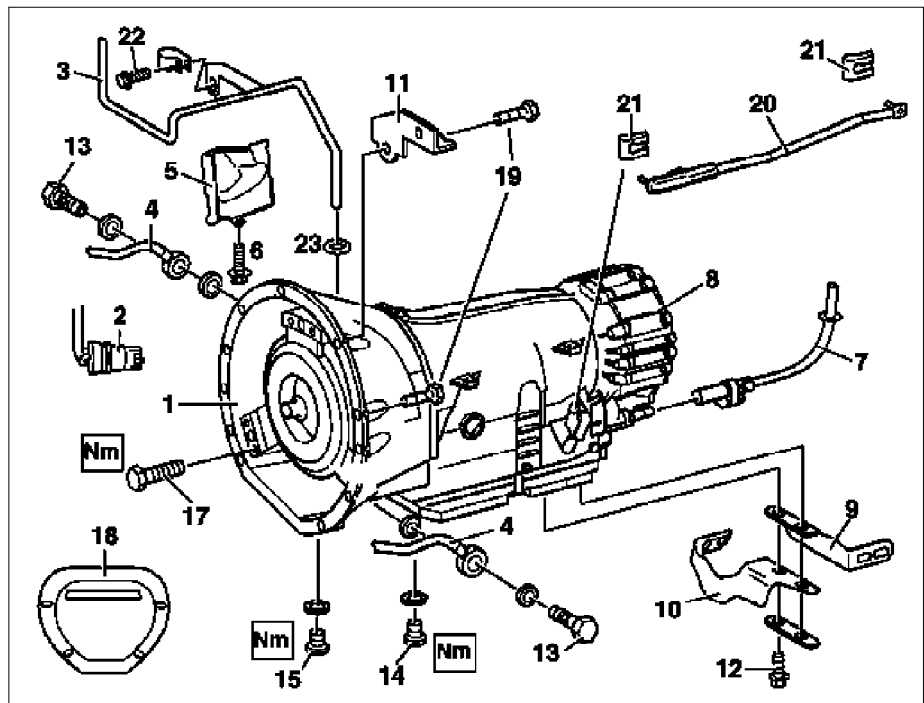

P27.10-0321-06

| | Remove/Install | | |
|---|---|---|----------------------------------|
| 1 | Disconnect ground cable of battery | Installation: Code radio, set clock, normalize power windows and set timer in vehicles with stationary heater. | AR54.10-P-0003A |
| 2 | Remove transfer case | | AR28.10-P-0100GH |
| 3 | Unbolt oil filler pipe (3) from crankcase | | |
| 4 | Remove heat shield (5) and disconnect 13-pin plug connector (2) | | |
| 5 | Remove locking clips (21) and remove shift rod (20) | Installation: Adjust shift rod. Pliers | AR27.60-P-0980B *210589003700 |
| 6 | Unscrew oil drain screw on oil pan (14) | | *BA27.10-P-1001-03A |

| | | | |
|----------|--|--|---|
| 7.1 | Unscrew oil drain screw for torque converter (15) | <p>i If the transmission fluid is burnt or contains wear particles, the oil cooler lines and oil cooler must be flushed out:# Flush oil cooler and oil cooler lines.</p> <p>Nm</p> <p>Transmission 722.6</p> | AR27.55-P-0001A *BA27.20-P-1001-01A BT27.20-P-0001-01A |
| k | Oil drain plug at torque converter no longer required | | |
| 8.1 | Detach wire for park lock interlock (7) at transmission | <p>i Only up to A145272, X708318. For installation and removal, position selector lever or range selector lever in position "P" and leave in position "P" when cable/transmission is removed.</p> <p>i Only up to A145272, X708318</p> <p>i Installation: Adjust cables for parking shift lock.</p> <p>i Installation: Check function of parking shift lock.</p> | AR27.60-P-0500-05B AR27.60-P-0965B |
| 9 | Lambda sensors for primary catalytic converters remove | | AR14.00-P-5303GH |
| 10 | Unscrew oil lines (4) to oil cooler from transmission | | |
| 11 | Remove cover in oil pan (18) and disconnect torque converter from driven plate at flange | Nm | *BA27.20-P-1002-01A |
| 12 | Unscrew bolts of transmission (19) at crankcase and take out transmission downwards at an angle using a lifting device | <p>i Push retainer (11) upwards.</p> <p>i Secure torque converter to prevent it from falling out.</p> <p>Nm</p> <p>III</p> | AR26.10-P-0020-02GH *BA27.40-P-1008-01A *WH58.30-Z-1009-07A |
| 13 | Remove torque converter | <p>i Installation: Grease the torque converter lightly on drive flange.</p> <p>S Handle</p> | AR27.20-P-0500-01B *BR00.45-Z-1010-06A *168589006200 |
| 14 | Install in the reverse order | | |
| 15 | Inspect ATF level in automatic transmission, add ATF if necessary | i When refilling or after an oil change, pour in approx. 5 l of transmission oil first. | AR27.00-P-0101A |

Nm Housing

| Number | Designation | Transmission 722.660/661/662/ 663/666/674 | | |
|--------------------|--|---|----|----|
| BA27.40-P-1008-01A | Bolt, automatic transmission to engine | M10X40 | Nm | 40 |
| | | M10X90 | Nm | 40 |
| | | M12 | Nm | - |

Nm Automatic transmission oil pan

| Number | Designation | Transmission 722.6 except 722.628/ 648/649 | |
|--------------------|---------------------------|--|----|
| BA27.10-P-1001-03A | Oil drain plug on oil pan | Nm | 20 |

Nm Torque converter

| Number | Designation | Transmission 722.6 |
|--------------------|---------------------------------------|-----------------------|
| BA27.20-P-1001-01A | Oil drain plug to torque converter | Nm 16 |
| BA27.20-P-1002-01A | Bolt, torque converter to drive plate | M8 Nm 42 |

Nm Transfer case, complete unit

| Number | Designation | Model 163 |
|--------------------|---|-----------|
| BA28.10-P-1003-01A | Bolt, adapter housing to transmission housing | Nm 20 |

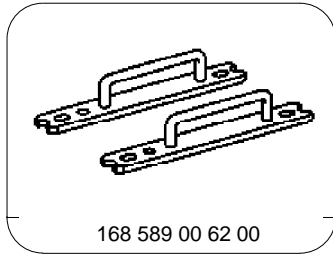

Grab handle

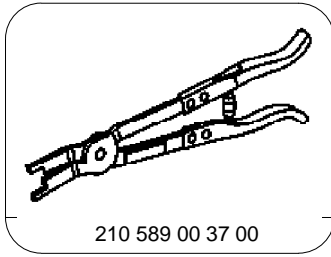

Pliers

Commercially available tools (see Workshop Equipment Manual)

| Number | Designation | Company (e.g.) | Order number |
|--------------------|--------------------|---|--------------|
| WH58.30-Z-1009-07A | Transmission plate | SLIFT Hebezeug GmbH Daimlerstrasse 9 75233 Tiefenbronn | GP MB |

Auxiliary repair materials

| Number | Designation | Order number |
|--------------------|---------------------|------------------|
| BR00.45-Z-1010-06A | Multi-purpose paste | 000 989 80 51 10 |