

TRANSMISSION**722.6**

- 97 Intermediate lever
- 112 Selector lever
- 116 Shift shaft
- 120 Shift detent
- 127 Pin
- 128 Shift gate
- 128a Rubber stop
- 136 Locking lever
- 137 Sleeve with shift detent carrier
- 138 Pin
- 138a Roller
- 138b Circlip

The center shift has been modified to improve operating convenience and dampen noise.

The intermediate lever (97) is rigidly connected to the shift shaft (116). A sleeve (137) with locking lever (136) is arranged on the shift shaft in such a way that it can move.

A roller (138a) attached to the shift detent carrier and two rubber stops (128b) on the shift gate (128) dampen noise during the transverse movement of the selector lever.

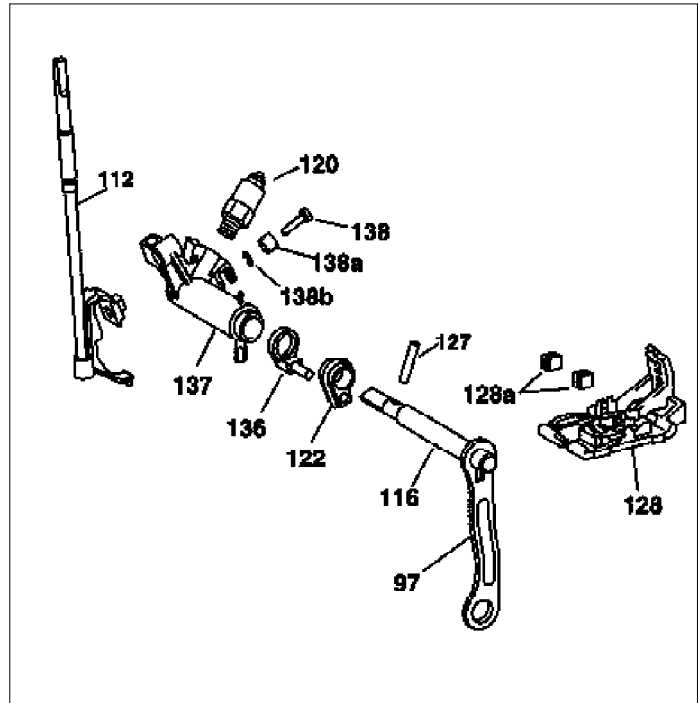

P27.60-0372-12