

ENGINE 112.942 in MODEL 163.154

ENGINE 112.970 in MODEL 163.157

ENGINE 113.942 in MODEL 163.172

Shown on engine 112

- 1 Air cleaner housing
 2 Resonance body
 3 Resonance pipe
 4 Viscous fan
 5 Fan shroud
 6 Bottom part of oil pan
 7 Nuts
 8 Bolts
 9 Air baffle
 W11/5 Ground strap of engine/body

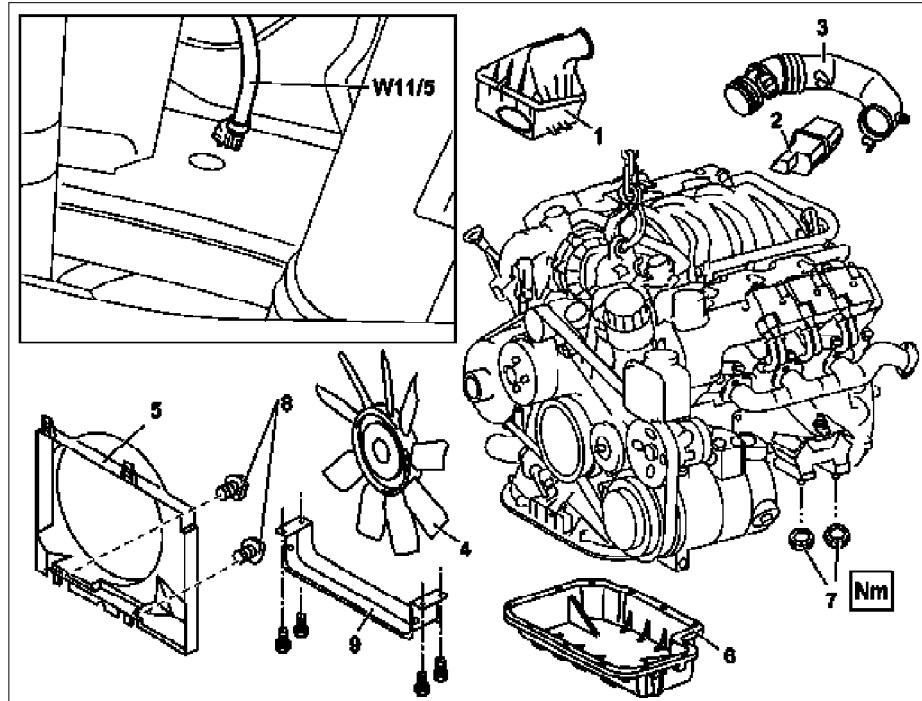

P01.45-2014-06

	Removing/installing		
			*001589760900
1	Remove engine trim panel		
2	Remove viscous fan (4)		Right-hand thread! AR20.40-P-5660C
3.1	Remove fan shroud (5).		Only engines 112.942 /970.
4.1	Remove air guide (9)		Only engine 113.942.
5	Drain and collect engine oil	 	*BA01.45-P-1003-01B *BF18.00-P-1001-01H
6	Unscrew nuts (7) at front suspension carrier		Before unbolting the left engine mount, press oil line of power steering out of fixture.
7	Remove resonance pipe (3) together with resonance body (2)		Do not damage the plastic strap.
8	Fit on engine supporting frame		The resonance pipe is attached at the rear at the intake manifold with a plastic plate.
9	Raise engine		Disconnect plug connection of hot film mass air flow sensor (HFM) and unscrew resonance pipe on cylinder head cover. Engines 112.942/970. Engines 112.912/946.
10	Unbolt bottom part of oil pan (6)		AR07.07-P-1454A AR07.07-P-1454MV AR33.10-P-0100-01BV *WH58.30-Z-1013-07A
			Engine lifting device for ML-class
			Ensure that the rear of the engine does not touch the body! Do not overstretch coolant lines and ground strap on engine/body (W11/5); remove ground strap on engine/body (W11/5) if necessary.
			*BA01.45-P-1002-01B

11	Remove bottom part of oil pan (6)	i Installation: Clean sealing surfaces, apply sealant to the sealing surfaces with a bead of 2.0 mm F 0.5 mm! The sealant must be applied within 10 minutes! The silicone bead must not be spread!	*BR00.45-Z-1015-01A
i	Notes on application of sealant to oil pan	Engine 112 Engines 112.912/946.	AH01.45-P-0001-01C AH01.45-P-0001-01E
12	Install in reverse order		

Nm Oil pan

Number	Designation		Engines 112.910/911/912/ 913/914/915/ 917/920/921/ 922/923/940/ 941/942/943/ 944/945/946/ 947/949/951/ 954/955/960/ 961/970/972/973	Engines 113.940/941/ 942/943/944/ 945/946/960/ 961/962/963/ 965/967/968/ 969/980/981/ 982/984/986/ 992
BA01.45-P-1002-01B	Self-tapping bolt of oil pan to oil pan	Thread not pretapped	Nm 14	14
		Thread pretapped	Nm 10	10
BA01.45-P-1003-01B	Oil drain plug on oil pan	M14	Nm 30	30

Nm Engine mounts, engine supports

Number	Designation		Engines 112.942/970 113.942/965/981 in models 163.154/157/172/ 174/175
BA22.10-P-1001-01L	Bolt of front engine mounts on front axle carrier		Nm 35

Engine lubrication

Number	Designation		Engine 112 except 112.916/953/975	Engines 113.940/941/942/ 943/960/961/ 962/967/982
BF18.00-P-1001-01H	Engine oil	Filling capacity with oil filter	Liters 8.0	8.0
		Filling capacity without oil filter	Liters 7.5	-
	Specifications for Operating Fluids		Sheet BB00.40-P-0229-01A	BB00.40-P-0229-01A
			Sheet BB00.40-P-0229-03A	BB00.40-P-0229-03A
			Sheet BB00.40-P-0229-05A	BB00.40-P-0229-05A

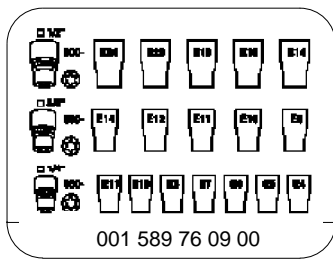

External Torx set

Commercially available tools (see Workshop Equipment Manual)

Number	Designation	Make (e.g.)	Order number
WH58.30-Z-1013-07A	Engine lifting device for ML-class	SPX (Europe) AG Kent-Moore Division for the attn. of: Mr. Hodel Oberneuhofstr. 1 CH-6340 Baar Fax:+4141/761-43-43 Fax:+4141/761-07-27 I SPX Corporation OE Tool+Equiement 28635 Mound Road Warren, MI 48092 Tel: 1-800-345-2233 Fax: 1-800-578-7375	0334.01

Auxiliary repair materials

Number	Designation	Order number
BR00.45-Z-1015-01A	Loctite sealant 5970	A 003 989 98 20 10