

MODEL 163.113 /136 /154 /157 /172 with CODE (221b) Electrically adjustable driver and passenger seat

MODEL 163.128 /174 /175



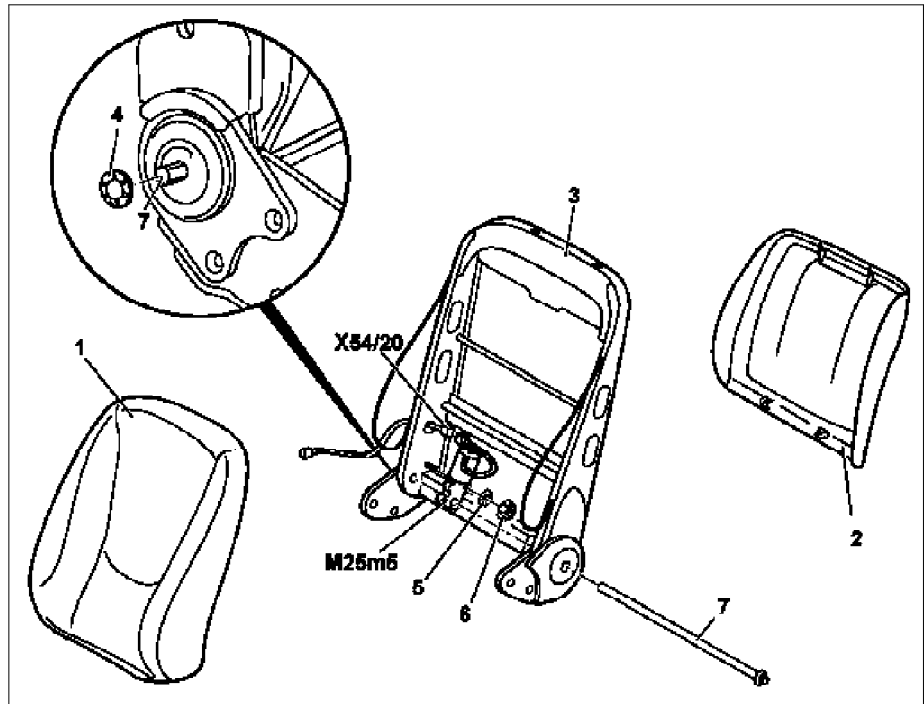

- 1 Front seat backrest cover
- 2 Backrest
- 3 Front seat backrest frame
- 4 Lock washer
- 5 Damper rubber
- 6 Nut
- 7 Adjusting shaft

M25m5 Backrest forward/back motor

X54/20 Backrest motor connector

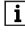
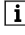
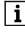

P91.29-0332-06

 	Remove/install		
1	Remove front seat backrest		AR91.10-P-1060GH
2	Remove backrest shell (2) from the front seat backrest		AR91.10-P-1915GH
3	Pull the insert rails on the front seat backrest cover (1) off the front seat backrest frame (3)	 Relieve the load on the front seat backrest cover by pressing down the front seat backrest frame.	
4	Pull off lock washer (4) of the adjusting shaft (7) on one side	 Installation: Replace lock washer.	
5	Unscrew nut (6) on backrest forward/back motor (M25m5)	 Installation: Replace self-locking nut.	
6	Remove damper rubber (5)		
7	Pull out adjusting shaft (7) sideways		
8	Disconnect backrest motor connector (X54/20) from backrest forward/back motor (M25m5)		
9	Remove backrest forward/back motor (M25m5)	 Lift up front seat backrest cushion approx. 10 cm from the front seat backrest frame.	
10	Install in the reverse order		